

Fronius KASAMAS *Speedglas* parweld SOLTER Kjellberg

Ádám és Ádám Kft

HEGESZTÉSTECHNIKA
FÉMSZÓRÁSTECHNIKA

Székhely: 4400 Nyíregyháza, Ószőlő út 99. Telephely: 4400 Nyíregyháza, Rákóczi út 102.
Tel.: +36 42 504-093, +36 42 504-094, +36 20 9449-003, +36 20 9555-417 Fax.: +36 42 504-095
E-mail: info@adam-adam.hu Weblap: www.adam-adam.hu Webshop: shop.adam-adam.hu

TTW 5000 A

(D) Ersatzteilliste
WIG-Handsweißbrenner

(GB) Spare Parts List
TIG Manual welding torch

(F) Liste de pièces de rechange
chalumeau manuelle TIG

(I) Lista parti di ricambio
cannello di saldatura WIG

(E) Lista de repuestos
Soplete para soldadura manual
TIG

Lista de peças sobresselentes
Queimador de soldadura MIG

www.fronius-hegesztogep.com

Ádám és Ádám Kft

4400 Nyíregyháza, Rákóczi út 102

Tel.: +36 42 504 093 +36 20 9449 003

4,035,796 TTW5000A F++ / 4m / 13,1ft
 4,035,797 TTW5000A F++ / 8m / 26,2ft

 4,035,798 TTW5000A F++ / UD / 4m / 13,1ft
 4,035,799 TTW5000A F++ / UD / 8m / 26,2ft

 4,035,808 TTW5000A F++ / JM / Le / 4m / 13,1ft
 4,035,809 TTW5000A F++ / JM / Le / 8m / 26,2ft

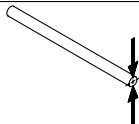
	Ø mm	Ø inch
	1,6-6,4	0,063-0,252



TTW 5000A F++/UD/JM/Le

Ersatzteilliste / Spare parts list / Listes de pièces de rechange / Lista de repuestos / Lista de peças sobresselentes / Lista dei Ricambi

STANDARD

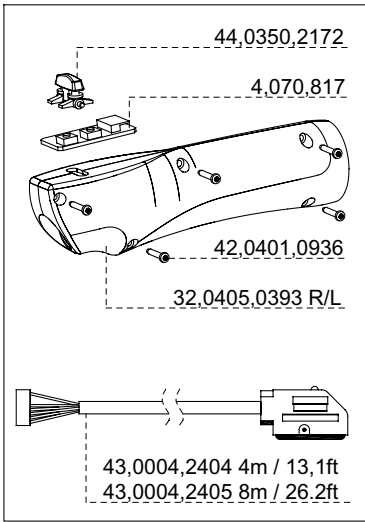

UP/DOWN

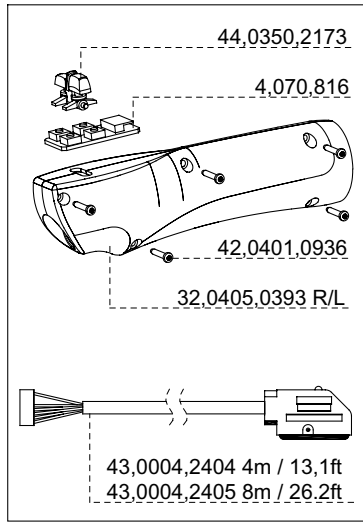

JOBMASTER

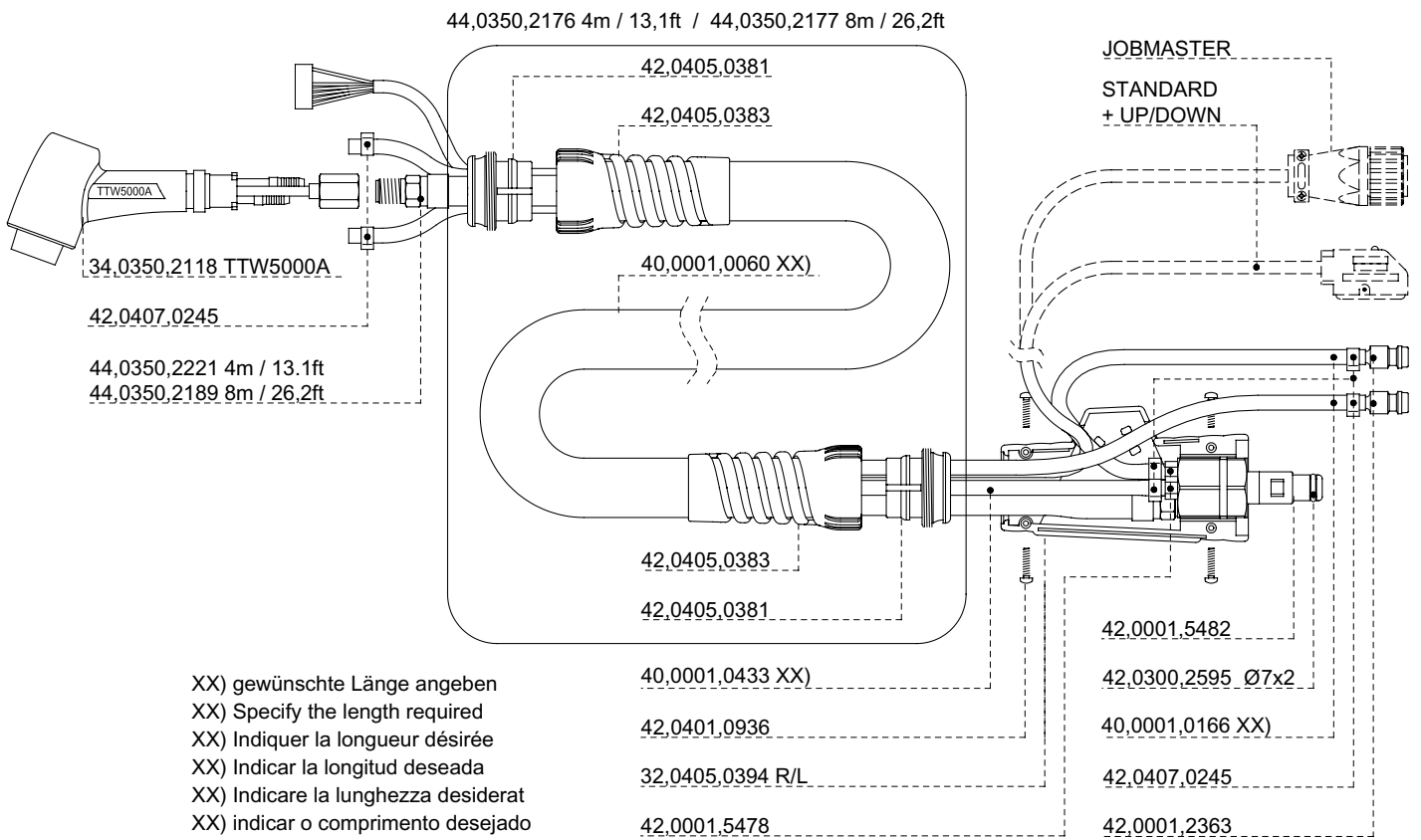
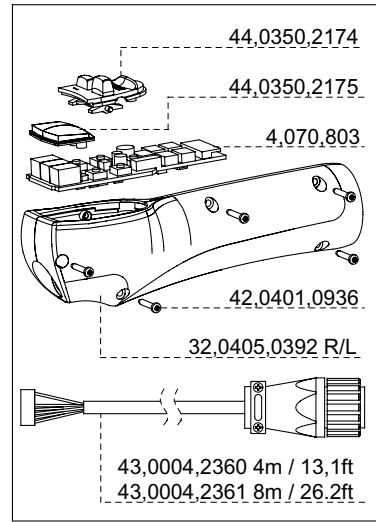

XX) gewünschte Länge angeben
XX) Specify the length required
XX) Indiquer la longueur désirée
XX) Indicar la longitud deseada
XX) Indicare la lunghezza desiderat
XX) indicar o comprimento desejado

OPTION - Leder / Leather / Cuir
44,0350,2180 4m / 13,1ft / 44,0350,2181 8m / 26,2ft

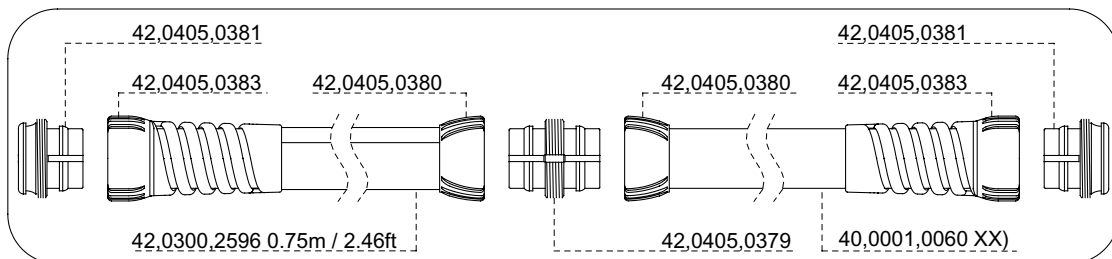

TTW 5000A F++/UD/JM/Le

Ersatzteilliste / Spare parts list / Listes de pièces de rechange / Lista de repuestos / Lista de peças sobresselentes / Lista dei Ricambi

Part No. clamping nut	Part No. collet	Part No. electrode WC20	Part No. electrode WP	Electrode Ø	
				Ø mm	Ø inch
42,0001,2278	42,0001,2276	42,0411,4001	42,0411,4008	1,6	0,063
42,0001,2279	42,0001,2277	42,0411,4002	42,0411,4005	2,4	0,094
42,0001,2272 X)	42,0001,2268 X)	42,0411,4003 X)	42,0411,4006	3,2	0,126
42,0001,2273	42,0001,2269	42,0411,4013	42,0411,4007	4,0	0,157
42,0001,2274	42,0001,2270	42,0411,4014	42,0411,4009	4,8	0,189
42,0001,2275	42,0001,2271	42,0411,4015		6,4	0,250

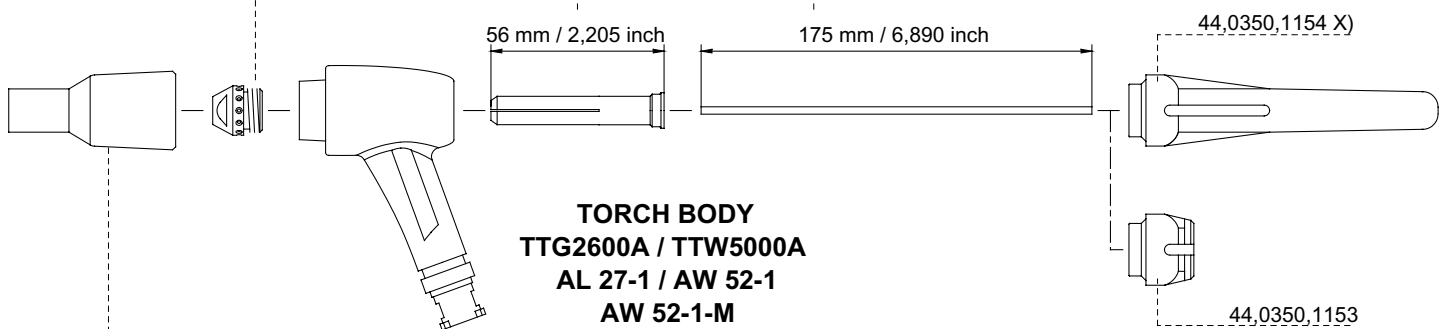

gas nozzle ceramic pluggable	L1		d1		d2		Part No.
	mm	inch	mm	inch	mm	inch	
	54	2,125	26.2	1,031	7,9	0,3125	42,0300,0707
					9,5	0,375	42,0300,0708
					11,1	0,4375	42,0300,0709 X)
					12,7	0,500	42,0300,0710
					15,9	0,625	42,0300,0711

- x) Standardausrüstung
- x) standard equipment
- x) équipement standard
- x) equipamiento estándar
- x) accessori standard
- x) equipamento de série



TTW 5000A F++/UD/JM/Le

Ersatzteilliste / Spare parts list / Listes de pièces de rechange / Lista de repuestos / Lista de peças sobresselentes / Lista dei Ricambi

3/3

www.fronius-hegesztogep.com

Ádám és Ádám Kft

4400 Nyíregyháza, Rákóczi út 102

Tel.: +36 42 504 093 +36 20 9449 003

FRONIUS INTERNATIONAL GMBH

Froniusplatz 1, A-4600 Wels, Austria

Tel: +43 (0)7242 241-0, Fax: +43 (0)7242 241-3940