

TTB 260 A G ML/70°/L65

44,0350,4410

TTB 260A G ML/70°/L65 (44,0350,4410)

Standard

| Part No. gas lens | Part No. insulation ring | Part No. head shield | Part No. collet | Part No. electrode WC20 | Part No. electrode WP | Part No. electrode WS2 | Electrode \varnothing | |
|-------------------|--------------------------|----------------------|-----------------|-------------------------|-----------------------|------------------------|-------------------------|------|
| | | | | | | | mm | inch |
| 44,0350,1595 | 42,0100,0401 | 42,0100,0408 x) | 42,0001,0284 | 42,0411,4012 | | | 1,0 | .039 |
| 44,0350,1362 | | | 42,0001,0285 | 42,0411,4001 | 42,0411,4008 | 42,0411,0161 | 1,6 | .063 |
| 44,0350,1363 | | | 42,0001,0286 x) | 42,0411,4002 x) | 42,0411,4005 | 42,0411,0162 | 2,4 | .094 |
| 44,0350,1364 | | | 42,0001,0287 | 42,0411,4003 | 42,0411,4006 | 42,0411,0163 | 3,2 | .126 |
| 44,0350,1365 | | | 42,0001,2577 | 42,0411,4013 | 42,0411,4007 | 42,0411,0164 | 4,0 | .157 |

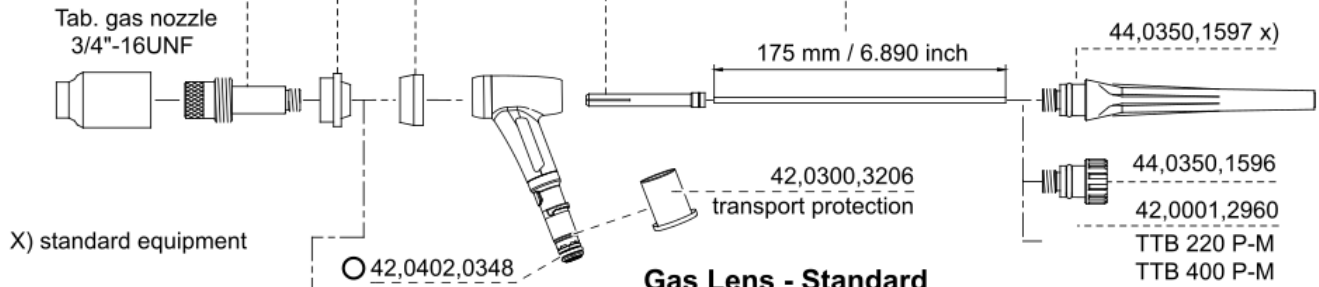

X) standard equipment

| Tab. Torch Body P | |
|-------------------|-------------|
| 44,0350,4409 | TTB 220 P |
| 44,0350,xxxx | TTB 220 P,F |
| 44,0350,4414 | TTB 400 P |
| 44,0350,xxxx | TTB 400 P,F |

| gas nozzle ceramic screwable 3/4" - 16UNF | d1 | | d2 | | L1 | | Part No. |
|---|------|------|------|------|------|-------|--------------|
| | mm | inch | mm | inch | mm | inch | |
| | 6,5 | .256 | 24,5 | .965 | 42 | 1.654 | 42,0300,2009 |
| | 8,0 | .315 | 24,5 | .965 | 42 | 1.654 | 42,0300,2010 |
| | 9,5 | .374 | 24,5 | .965 | 42 | 1.654 | 42,0300,2011 |
| | 11,0 | .433 | 24,5 | .965 | 42 | 1.654 | 42,0300,2012 |
| | 12,5 | .492 | 24,5 | .965 | 42 | 1.654 | 42,0300,2013 |
| | 8,0 | .315 | 24,0 | .945 | 76 | 2.992 | 42,0300,2273 |
| | 9,5 | .374 | 24,0 | .945 | 76 | 2.992 | 42,0300,2274 |
| | 9,5 | .374 | 24,0 | .945 | 59,1 | 2.327 | 42,0300,2826 |
| | 11,0 | .433 | 24,0 | .945 | 76 | 2.992 | 42,0300,2275 |

Gas Lens - Large

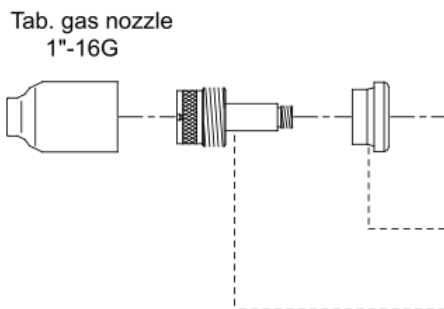

| Part No. insulation ring | Part No. collet body | Electrode \varnothing | |
|--------------------------|----------------------|-------------------------|------|
| | | mm | inch |
| 42,0100,0402 | 42,0001,3027 | 1,0 | .039 |
| | 42,0001,3028 | 1,6 | .063 |
| | 42,0001,3029 | 2,4 | .094 |
| | 42,0001,3030 | 3,2 | .126 |
| | 42,0001,3031 | 4,0 | .157 |

Gas Lens - Large

| gas nozzle ceramic screwable 1" - 16G | d1 | | d2 | | L1 | | Part No. |
|---------------------------------------|------|------|------|-------|----|-------|--------------|
| | mm | inch | mm | inch | mm | inch | |
| | 9,5 | .374 | 30,3 | 1.193 | 48 | 1.890 | 42,0300,2247 |
| | 12,5 | .492 | 30,3 | 1.193 | 48 | 1.890 | 42,0300,2248 |
| | 16,0 | .630 | 31,0 | 1.220 | 48 | 1.890 | 42,0300,2249 |
| | 19,0 | .748 | 31,0 | 1.220 | 48 | 1.890 | 42,0300,2250 |